

Intraoral Light Sources, Bulbs, and Tooth Dryer

Quad Voltage Intraoral Light Source



- Fiber-optic intraoral light source
- Requires fiber-optic handpiece tubing, 24vac
- All IOLS come equipped to light (2) handpieces
- A-dec 300 kit equipped to light (4) handpieces
- To add additional handpieces order the QVIOLS Switch Kit

IOLS kit for A-dec 300

PRODUCT DESCRIPTION	PART NUMBER	PRICE
Quad Volt IOLS kit for A-dec 300 (equipped to light (4) handpieces)	90.1168.00	
Quad Volt IOLS kit for Performer	76.8112.00	
Quad Volt IOLS kit for 2122/2132	90.1358.00	
Quad Volt IOLS kit for 3420/2561	90.1359.00	
Quad Volt IOLS kit for 4631	90.1360.00	
QVIOLS Switch Kit	90.1382.00	

Tooth Dryer End Cap Parts

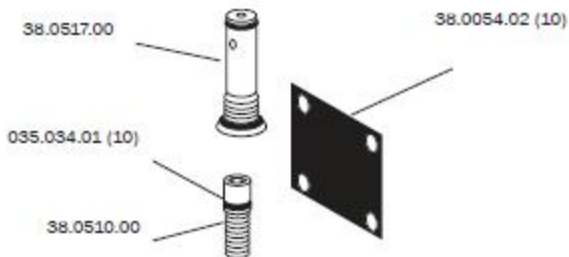

Tooth Dryer

11.0232.00



- For tubing options, see pages 39-40
- Handpiece only

Tooth Dryer Relay Valve

34.0043.00



- 1/8" barb (1)
- 1/4" barbs (2)

A-dec replacement bulbs



Xenon, 3.5V, .75A

FOR 5-HOLE HANDPIECE TUBING	PART NUMBER	PRICE
Xenon, 3.5V, .75A	041.317.00	

A-dec | W&H replacement bulbs



For 896, 898, 898-LE, TA-96L, TA-98L

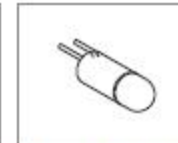

For EB-40LT electric handpiece



EA-40LT, EA-50LT, EA-51LT, and A-25LT electric motor



For RA-24 Roto-Quick

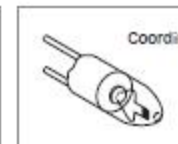

For LT25 lowspeed motor and 6-pin to 5-hole adapter

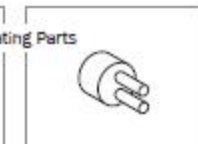

Spacer for 6-pin to 5-hole adapter

BULB BY HANDPIECE MODEL	PART NUMBER	PRICE
for 896, 898, 898LE, TA-96L, TA-96L	0.02207610	
for EB-40LT electric handpiece	0.04059400	
for EA-40LT, EA-50LT, EA-51LT, AM-25LT and A-25LT electric motor	0.04300400	
for RA-24 Roto-Quick	0.03523010	
for LT25 lowspeed motor and 6-pin to 5-hole adapter	0.01905510	
bulb spacer for 6-pin to 5-hole adapter	0.02752600	
EA-52LED Bulb	0.06189400	