

# Century Plus

## Century Plus Control Block

38.0540.00

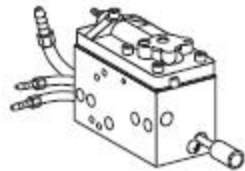

- With pigtails

## Century Plus Cartridges

38.0517.00 Air bleed

38.0518.00 Check valve

38.0520.00 Water valve



Air bleed  
(brass base)



Check valve  
(blue base  
with duckbill)



Water valve  
(red base)

## Drive Air Flow Adjustment Stem

38.0510.00 Stem

035.034.01 O-ring (10)



- Includes O-ring

## Water Coolant Flow Adjustment Stem

38.0516.00 Stem

035.034.01 O-ring (10)



- Includes O-ring

## Syringe Flow Control Barb

38.0555.00

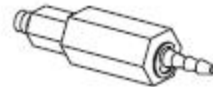

- For air and water
- 1/8" barb
- 10-32 threaded fitting

## Flush Valve Stem

38.0525.00 Stem

035.033.01 O-ring (10)

034.001.01 O-ring (10)

013.072.00 Spring

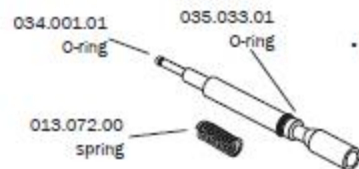

- Includes O-rings

## Air Coolant Flow Adjustment Stem

38.0526.00 Stem

030.003.02 O-ring (10)



- Includes O-ring

## Handpiece Control Adjustment Keys

98.0867.02 (5)



- Autoclavable adjustment keys
- For use in Cascade and Decade 4400 handpiece controls

## Gauge, Horizontal

026.083.01



- Panel mount
- 0 - 60 psi
- 1/2" x 1 3/4"
- 6-32 mounting holes
- 10-32 port
- Includes 1/8" barb