

# Aspirator Tips and Brushes

## High Volume Aspirator Tips

- 10.0010.02 6" (5)
- 11.0160.02 4<sup>1</sup>/<sub>2</sub>" (5)



- Autoclavable
- Stainless steel
- 7/16" diameter OD
- 6" and 4<sup>1</sup>/<sub>2</sub>" lengths available

## Disposable High Volume Aspirator Tip

- 11.0230.01 (100)



- Non-autoclavable
- White polyethylene material
- 7/16" diameter OD
- 5" long

## Autoclavable 90° High Volume Aspirator Tip

- 10.0014.01 Tip (5)
- 10.0015.00 Tip assembly



- Stainless steel
- 7/16" diameter OD

## Surgical Aspirator Tips

- 11.0070.00 1/8" OD
- 11.0090.00 3/16" OD
- 11.0170.00 5/16" OD (Ohio)



- Autoclavable stainless steel tip
- Adapts to the AVS and central vacuum HVE valve, includes cleaning brush

## Surgical Tip Brushes

- 049.005.01 1/8" (6)
- 049.002.01 3/16" (6)



## Vacuum Valve Brushes

- 049.001.01 1/2" (6)
- 049.004.01 3/4" (6)



- Use 1/2" for AVS
- Use 3/4" for 15 mm European and standard

## Oral Cups and Liners

- 11.0440.00 Molded
- 11.0490.00 Liners (1000)



- Molded and metal oral cups require paper liners

## Dual HVE Conversion Kit

- 11.1009.00 Cascade
- 90.1028.00 4631/4635 kit

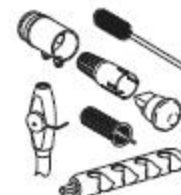

- Includes HVE and tubing assembly, cap, screen, tailpiece, holder bar, and vacuum connector

## Performer HVE Conversion Kit

- 11.1147.00 Performer kit  
(includes one HVE)



- Includes HVE and tubing assembly, cap, screen, tailpiece, and vacuum connector