

Footswitches and Rear Cover Kit

8-Button Footswitch

62.0163.01 Programmable Footswitch, Gray 3

For use on all current A-dec chairs

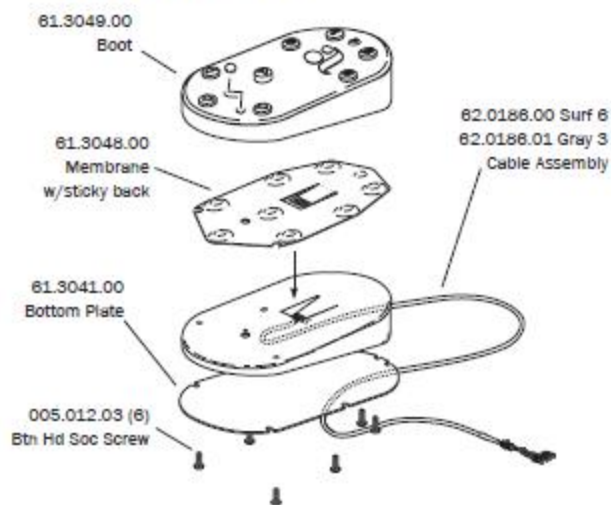

Multi-Function Footswitch

Service Parts Only

002.015.00 Screw Pan HD Phillips, 6-32 x 3/8"	
011.052.00 Dowel Pin 0.125" Dia x 0.50" long, Stainless Steel	
015.015.00 Ball 0.250" Dia, Stainless Steel	
017.007.01 Rubber Bumpers (25) 0.50" Dia, Gray	
61.0335.00 Tapered Spacer	
61.0336.00 Spacer	
004.010.00 Flat Washer 0.128 ID, Fiber	
041.059.00 Push Button Switch 1P1T, 5A, 120V, Normally Open, Momentary	
61.0976.02 Cable Assembly Surf 6	

8-Function Footswitch*

Service Parts Only

8 Function Footswitch (Part No. 61.2027.00) replaced by 8-button Footswitch in 1997

*Base and Cover Assy Not Available For Sale

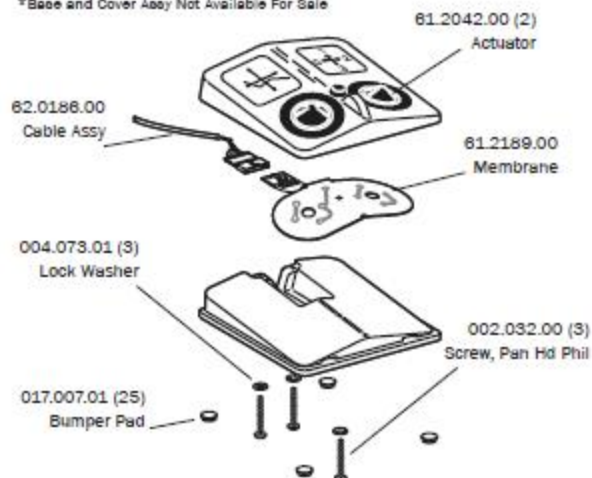

A-dec 300 Rear Cover Kit

90.1266.00

